

## B1203 - Collar Nut

- ▶ Tempered steel
- ▶ Blackened
- ▶ Height 1.5xD

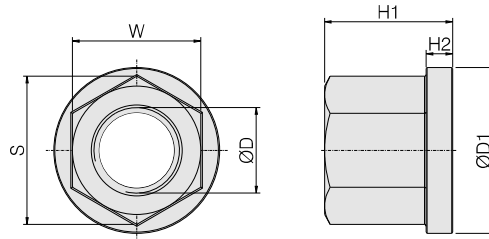

Part No.	ØD	S	H1	W	D1	H2	Weight (Kg)
B1203-M10	M10	19.6	15	17	22	4	0.028
B1203-M12	M12	21.9	18	19	25	4	0.037
B1203-M16	M16	27.7	24	24	31	5	0.073
B1203-M20	M20	34.6	30	30	37	6	0.138
B1203-M24	M24	41.6	38	36	45	6	0.237

## B1205 - Extension Nut

- ▶ Tempered steel
- ▶ Blackened
- ▶ Height 3xD

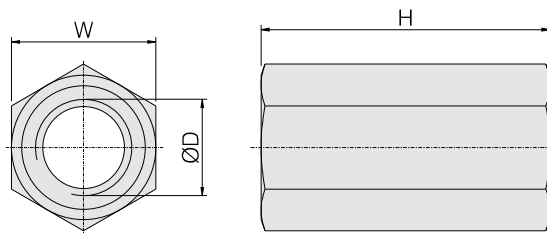

Part No.	ØD	H	W	Weight (Kg)
B1205-M8	M8	24	13	0.020
B1205-M10	M10	30	17	0.038
B1205-M12	M12	36	19	0.054
B1205-M14	M14	42	21	0.087
B1205-M16	M16	48	24	0.12
B1205-M20	M20	60	30	0.25
B1205-M24	M24	72	36	0.43
B1205-M30	M30	90	46	0.89